



Conference Set Instructions



engineering excellence

Before assembling the frame identify the elements (diagram shows rear of frame).

 = Magnetic tape
 = Velcro tape

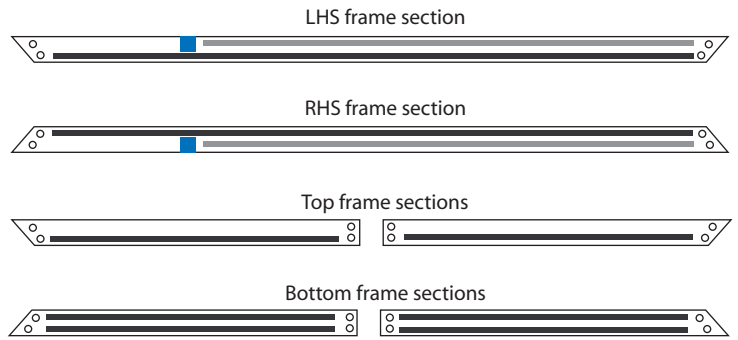

Counter Sunk Screw x 24

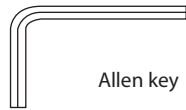

Allen key

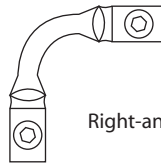

Right-angled connector x 8

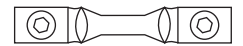

Straight connector x 4

Insert the connectors into the frame then screw the frame together using the supplied counter sunk screws.

Note: Do not fully tighten until all screws are in place.

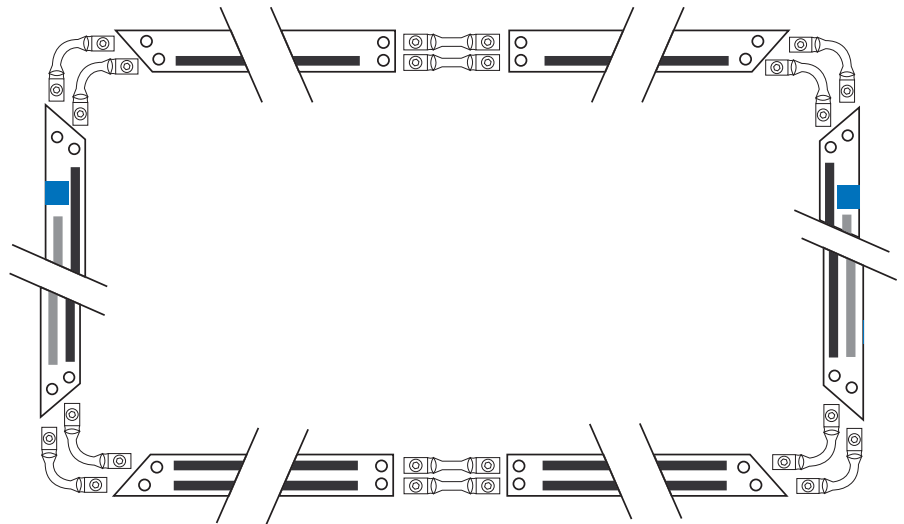

Once the frame is assembled attach the screen to the Velcro around the rear of the frame.

Keep stretching the screen until the desired tension is achieved.

Note: this is best performed on the floor or a large flat service.

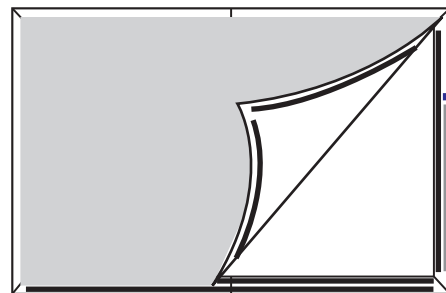

Hang the completed frame assembly by placing the blue hanging lugs on the rear of the screen frame over the blue pins located on the top of the Pop-Up frame.

Push the back of the lower three panels onto the Velcro on the screen frame.

Note: For safety, and to avoid damage, hanging the screen frame should be performed by TWO PEOPLE.

